



## JW Marriott Parq Vancouver

39 Smithe Street, Vancouver, British Columbia V6B 0R3 Canada  
Phone 604.566.8808    [jwmarriottparqvancouver.com](http://jwmarriottparqvancouver.com)

Rising against a backdrop of majestic coastal mountains on Canada's pristine Pacific coast, the JW Marriott® Parq Vancouver unveils a quintessential meeting destination—built for LEED® Gold Certification—in the heart of downtown Vancouver's vibrant entertainment district. More than 60,000 square feet of indoor and outdoor urban event space is complemented by authentic experiences like Chef on Show culinary presentations, flexible event lounges and grand spaces that entertain open exchange and productivity, opening your group up to new ideas and replenished spirits.

### Location

Located within Parq Vancouver, the focal point of the city's energetic downtown entertainment district, where guests enjoy instant access to a breadth of amenities, including eight restaurants & lounges, an elevated sixth floor park and world-class gaming • Walkable to iconic Vancouver neighborhoods like Gastown and Yaletown, in addition to BC Place

### Accommodations

Designed by acclaimed Studio Munge, known for sumptuous, luxurious residential design • 329 exquisite guest rooms, including 44 suites, 3 luxury suites and a striking two-floor villa • Amenity-laden to accommodate the needs of both the business and leisure traveler • Groups can also enjoy access to 188 additional rooms and suites within Parq Vancouver at the DOUGLAS, an Autograph Collection® hotel

### Restaurants & Lounges

A smart location within the cultural hub of Parq Vancouver allows guests effortless access to eight world-class restaurants & lounges led by James Beard Award—nominated masterminds Elizabeth Blau and her husband, Chef Kim Canteenwalla.



Meetings Enriched  
by a Natural Brilliance

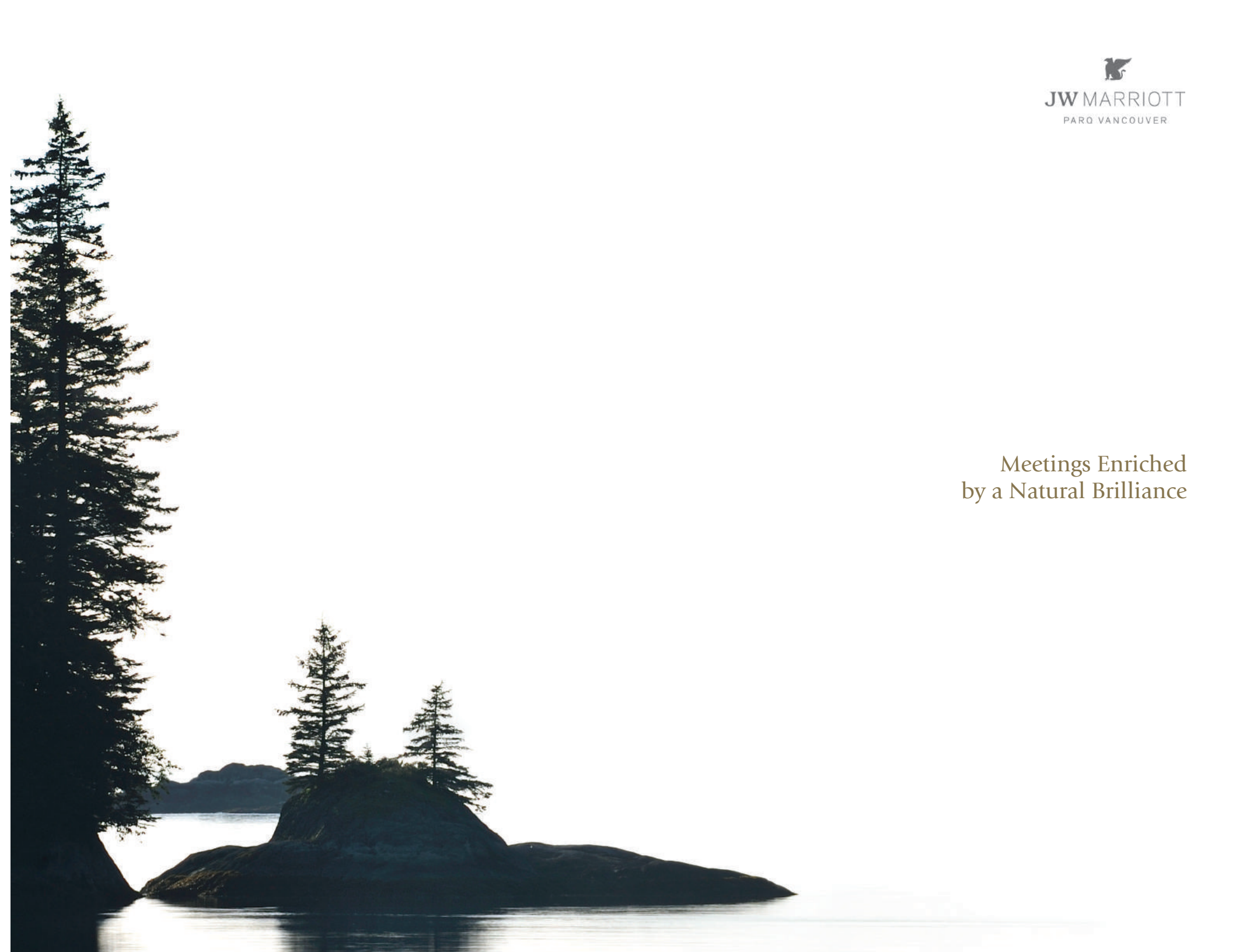



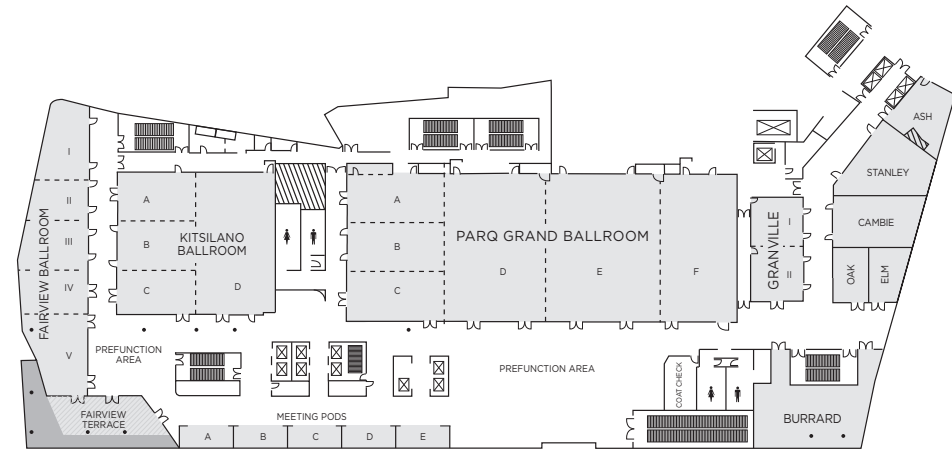

Meeting Space Highlights

- A contemporary hotel inspired by its natural surroundings and crafted for LEED Gold Certification
- 60,000 square feet of flexible function space, all conveniently located on one level
- 15,604-sq-ft Parq Grand Ballroom, Vancouver's largest, features 23-foot ceilings and accommodates 1,144 guests
- Two additional ballrooms offer flexibility to accommodate smaller events
- 30,000-sq-ft rooftop greenspace with capability for outdoor dining
- 22 breakout rooms with floor-to-ceiling views and state-of-the-art audio-visual technology
- Wired and wireless Internet access
- Events by JW – creating extraordinary events led by Chefs on Show culinary presentations

	DIMENSIONS		CAPACITY							
	LxWxH	Sq Ft	Classroom	Conference	Theatre	Banquet	Reception	8x10 Booth	10x10 Booth	U-Shape
<b>Parq Grand Ballroom</b>	77'x203'x23'	15,604	936	–	1,144	1,140	1144	86	72	–
<b>Salon A</b>	26'x48'x23'	1,235	72	36	90	90	90	–	–	36
<b>Salon B</b>	26'x48'x23'	1,228	60	36	60	60	60	–	–	36
<b>Salon C</b>	26'x48'x23'	1,233	72	36	90	90	90	–	–	36
<b>Salon D</b>	54'x76'x23'	4,105	252	–	306	300	306	24	20	86
<b>Salon E</b>	54'x76'x23'	4,109	252	–	314	310	314	24	20	86
<b>Salon F</b>	48'x77'x23'	3,689	216	–	280	270	270	24	20	70
<b>Parq Grand Ballroom Prefunction</b>		6,300	–	–	–	–	600	32	25	–
<b>Kitsilano Ballroom</b>	80'x74'x18'	5,909	324	–	422	420	423	33	26	–
<b>Salon A</b>	23'x40'x18'	926	54	30	70	60	70	6	3	30
<b>Salon B</b>	27'x40'x18'	1,099	54	30	60	60	60	6	6	30
<b>Salon C</b>	23'x40'x18'	926	54	24	68	60	68	5	3	24
<b>Salon D</b>	74'x40'x18'	2,950	144	48	224	210	200	17	13	48
<b>Kitsilano Ballroom Prefunction</b>		2,500	–	–	–	–	150	6	6	–

	LxWxH	Sq Ft	Classroom	Conference	Theatre	Banquet	Reception	8x10 Booth	10x10 Booth	U-Shape
<b>Fairview Ballroom</b>	–	4,456	–	138	308	280	325	–	–	–
<b>I</b>	32'x22'x18'	700	30	24	40	40	40	–	–	24
<b>II</b>	28'x28'x18'	786	36	24	50	50	50	–	–	24
<b>III</b>	28'x34'x18'	947	45	18	68	50	60	–	–	24
<b>IV</b>	22'x35'x18'	786	36	24	50	50	56	–	–	24
<b>V</b>	28'x45'x18'	1,237	54	30	90	70	80	–	–	36
<b>Fairview Terrace</b>		976	–	–	–	77	77	–	–	–
<b>Granville</b>	32'x26'x10'	1,638	72	48	124	100	100	–	–	48
<b>I</b>	32'x26'x10.5'	832	36	24	62	50	40	–	–	24
<b>II</b>	32'x25'x10.5'	806	36	24	62	50	40	–	–	24
<b>Stanley</b>	24'x42'x10.5'	1,087	60	24	80	50	60	–	–	24
<b>Cambie</b>	25'x43'x10.5'	1,065	60	24	80	50	60	–	–	24
<b>Burrard</b>	32'x55'x10.5'	1,760	66	30	120	100	120	–	–	38
<b>Ash Boardroom</b>	18'x29'x10'	581	–	12	–	–	–	–	–	–
<b>Oak Boardroom</b>	29'x16'x10'	472	–	12	–	–	–	–	–	–
<b>Elm Boardroom</b>	26'x17'x10'	430	–	12	–	–	–	–	–	–