



JW MARRIOTT
PARO VANCOUVER

INSPIRED EVENTS.
THOUGHTFULLY CRAFTED.

EVENTS by JW



ARTFUL SPACES TO ENRICH YOUR IDEAS

Rising against a backdrop of majestic coastal mountains on Canada's pristine Pacific coast, the JW Marriott® Parq Vancouver unveils a quintessential meeting destination—built for LEED® Gold Certification—in the heart of downtown Vancouver's vibrant entertainment district. More than 60,000 square feet of indoor and outdoor urban event space is complemented by authentic experiences like “Chef on Show” culinary presentations, flexible event lounges and grand spaces that entertain open exchange and productivity, opening your group up to new ideas and replenished spirits.

	DIMENSIONS			CAPACITY						
	LxWxH	SQ FT	CLASSROOM	CONFERENCE	THEATRE	BANQUET	RECEPTION	8x10 BOOTH	10x10 BOOTH	U-SHAPE
Parq Grand Ballroom	77'x203'x23'	15,604	936	-	1,144	1,140	1,144	86	72	-
Salon A	26'x48'x23'	1,235	72	36	90	80	90	-	-	36
Salon B	26'x48'x23'	1,228	60	36	60	60	60	-	-	36
Salon C	26'x48'x23'	1,233	72	36	90	80	90	-	-	36
Salon D	54'x76'x23'	4,105	252	-	306	300	306	24	20	86
Salon E	54'x76'x23'	4,109	252	-	314	310	314	24	20	86
Salon F	48'x77'x23'	3,689	216	-	280	270	270	24	20	70
Parq Grand Ballroom Prefunction	-	6,300	-	-	-	-	600	15	15	-
Kitsilano Ballroom	80'x74'x18'	5,909	324	-	422	380	423	33	26	-
Salon A	23'x40'x18'	926	54	30	70	60	70	6	3	30
Salon B	27'x40'x18'	1,099	54	30	60	60	60	6	6	30
Salon C	23'x40'x18'	926	54	24	68	60	68	5	3	24
Salon D	74'x40'x18'	2,950	144	48	224	210	200	17	13	48
Kitsilano Ballroom Prefunction	-	2,500	-	-	-	-	250	5	5	-

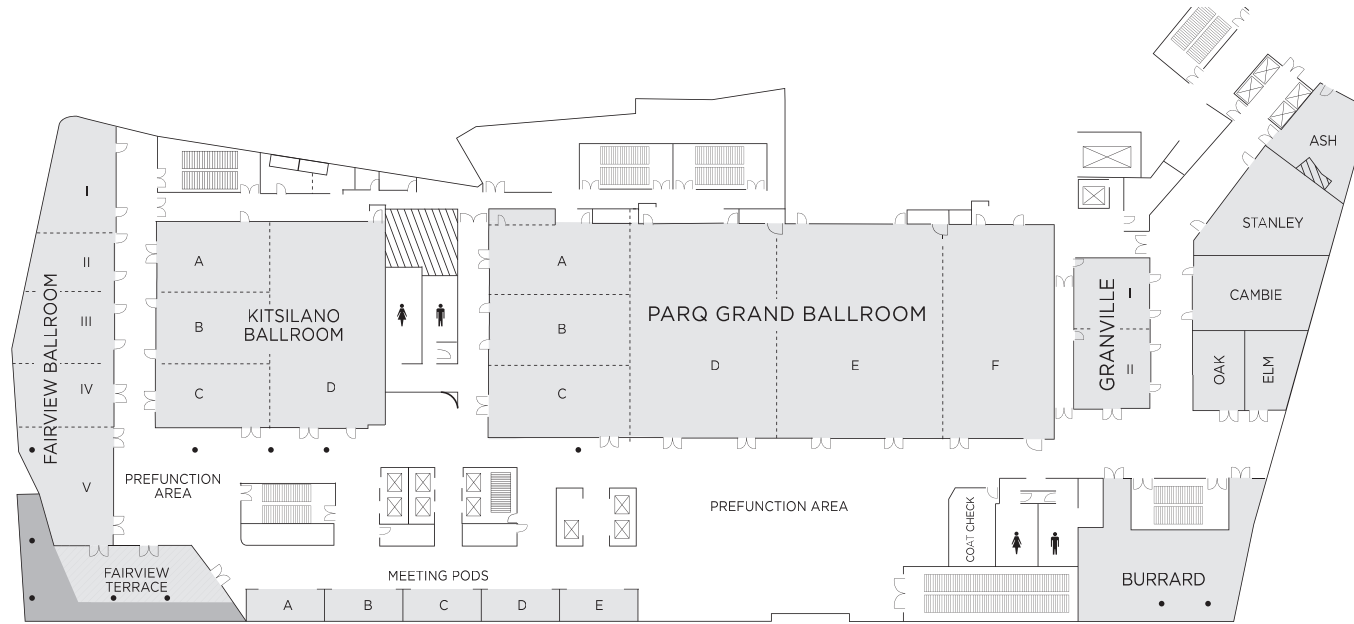

	DIMENSIONS		CAPACITY							
	LxWxH	SQ FT	CLASSROOM	CONFERENCE	THEATRE	BANQUET	RECEPTION	8X10 BOOTH	10X10 BOOTH	U-SHAPE
Fairview Ballroom	-	4,456	-	-	308	280	325	-	-	-
Fairview I	32'x22'x18'	700	30	24	40	40	40	-	-	24
Fairview II	28'x28'x18'	786	36	24	50	50	50	-	-	24
Fairview III	28'x34'x18'	947	45	18	68	50	60	-	-	24
Fairview IV	22'x35'x18'	786	36	24	50	50	56	-	-	24
Fairview V	28'x45'x18'	1,237	54	30	90	70	80	-	-	36
Fairview Terrace	-	976	-	-	60	40	30	-	-	-
Ash Boardroom	18'x29'x10'	581	-	12	-	-	-	-	-	-
Oak Boardroom	29'x16'x10'	472	-	12	-	-	-	-	-	-
Elm Boardroom	26'x17'x10'	430	-	12	-	-	-	-	-	-
Granville	32'x26'x10'	1,638	72	48	124	100	100	-	-	48
Granville I	32'x26'x10.5'	832	36	24	62	50	40	-	-	24
Granville II	32'x25'x10.5'	806	36	24	62	50	40	-	-	24
Stanley	24'x42'x10.5'	1,087	60	24	80	50	60	-	-	24
Cambie	25'x43'x10.5'	1,065	60	24	80	50	60	-	-	24
Burrard	32'x55'x10.5'	1,760	66	30	120	100	120	-	-	38

